

PLAN SHOWING LEASE BOUNDARY OF T. C. No. 83/52 ON GEOREFERENCED & VECTORISED CADESTRAL MAP
SITUATED IN VILLAGE SURLA, BICHOLIM TALUKA OF NORTH GOA DIST., GOA

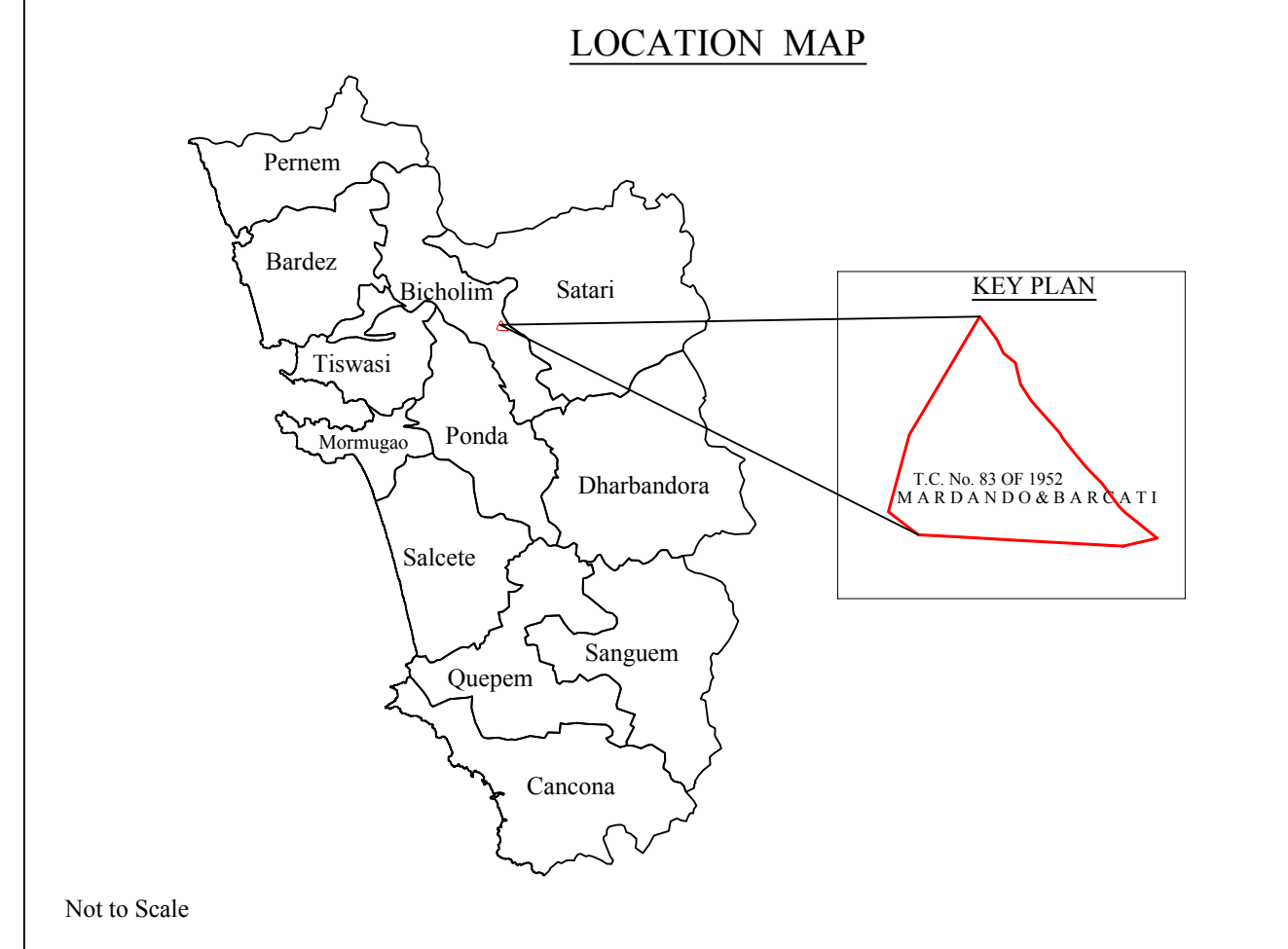
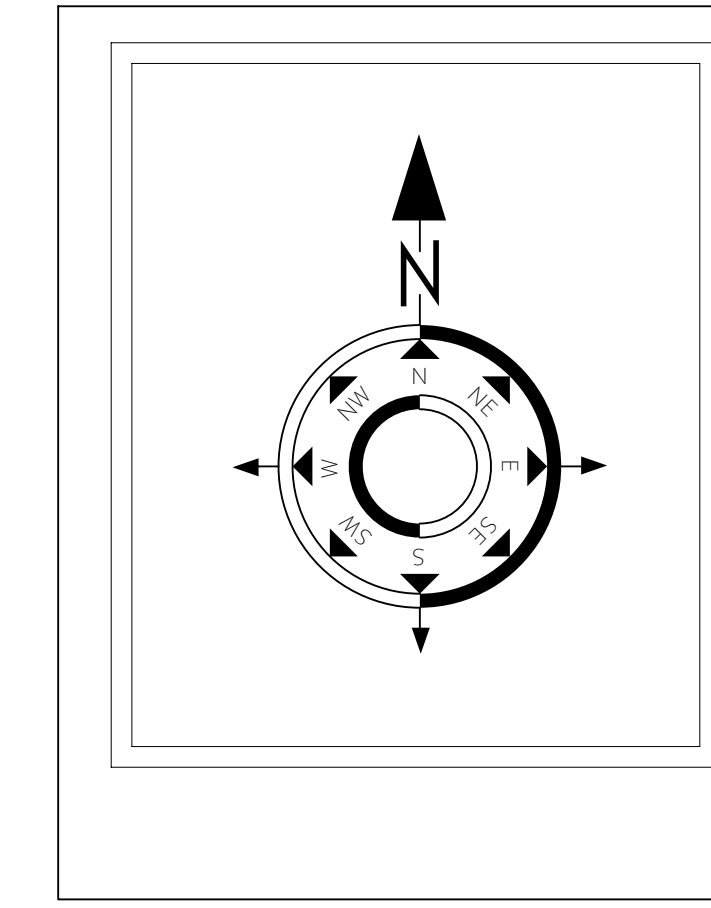
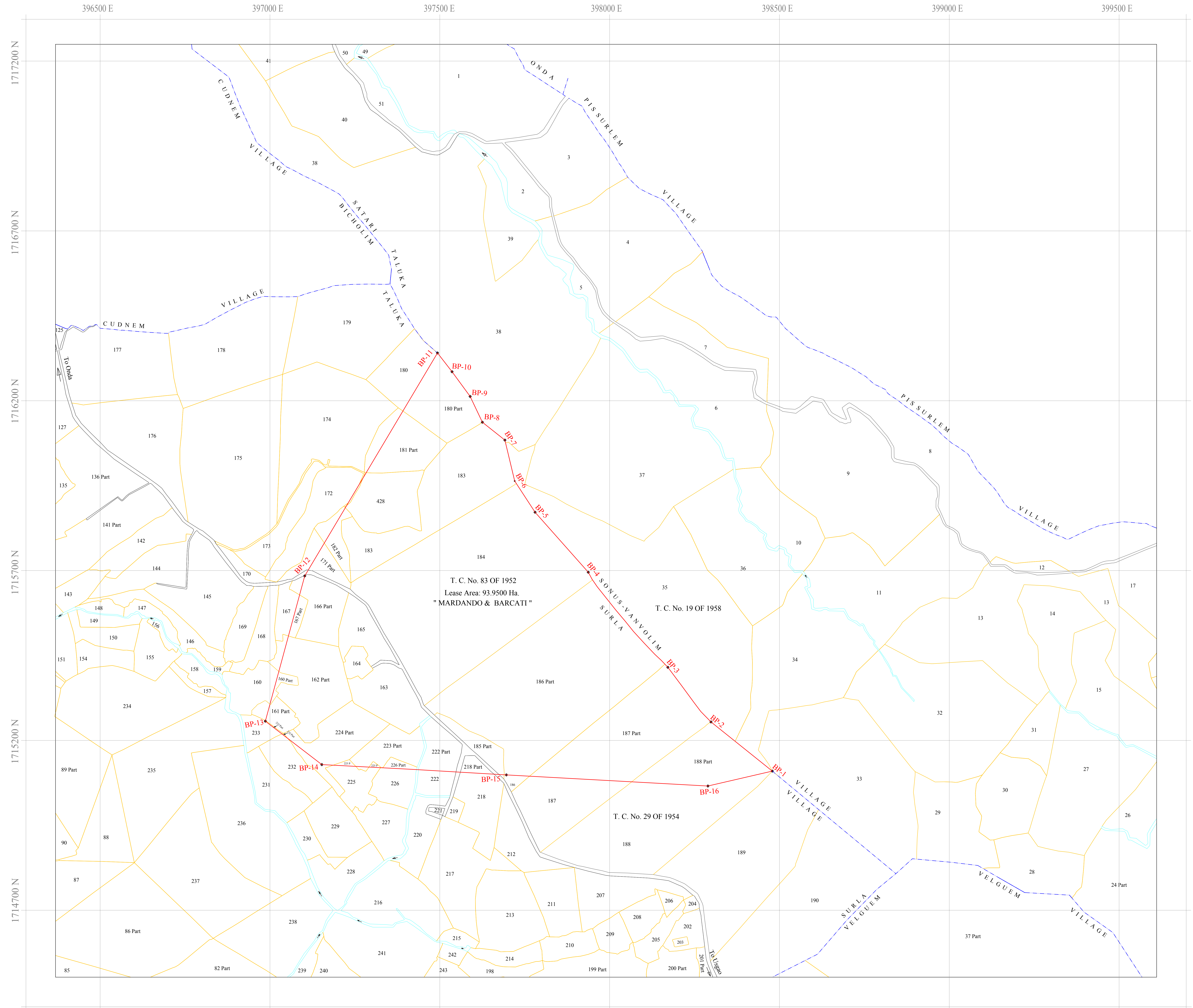

MAP DATUM : WGS 84
PROJECTION : UTM, Zone: 43 North

Geo Referenced and Vectorised Cadastral Map of T. C. No. 83 OF 1952
Lease Name: MARDANDO & BARCATI
Lessee: V.M.SALGAOCAR & BRO. PVT. LTD.
Location: Situated in Village Surla of Bicholim Taluka, North Goa District, Goa State.
Area : 93.9500

SURVEYED & PREPARED BY
M/s. GEOFINY TECHNOLOGIES (P) LIMITED
No.352/1B, RAJIV GANDHI SALA(OMR), TAMBARAM TALUK, CHENNAI-600 119.
Empanelled by
Directorate of Mines and Geology
Govt of GOA, PANAJI
Vide order no:01/593/10-mines/203 Dated: 05/04/2013
Survey carried-out on 16th May 2013

CERTIFICATE
This is to certify that the Mining lease boundary pillars of T.C.No. 83 of 1952 have been surveyed using DGPS (Differential Global Positioning System) based up on the Total Station survey conducted earlier.
Mr. B. Unnikrishnan Nair
(Mines Manager)

CERTIFICATE
This is to certify that the boundary pillars of T. C. No. 83 OF 1952 as shown by Mr. B. Unnikrishnan Nair (Mines Manager) has been surveyed by our team led by Mr. K. Velmurugan using DGPS. The lease map and pillar locations have been verified, survey conducted and plans prepared as per requirement of IBM circular No.2 /2010 Dated 06-04-2010.
For Geofiny Technologies (P) Ltd.
K. Velmurugan

B.P.No	LATITUDE	LONGITUDE	EASTING	NORTHING
1	15° 30' 40.8771" N	74° 03' 12.3632" E	398478.9900	1715109.6600
2	15° 30' 45.5598" N	74° 03' 06.2841" E	398298.5020	1715254.3510
3	15° 30' 50.7722" N	74° 03' 01.9974" E	398171.4940	1715415.2410
4	15° 30' 59.8564" N	74° 02' 54.0878" E	397937.0740	1715695.2760
5	15° 31' 05.5763" N	74° 02' 48.8072" E	397780.5280	1715871.7400
6	15° 31' 08.5608" N	74° 02' 46.7787" E	397720.4990	1715963.7190
7	15° 31' 12.4771" N	74° 02' 45.7909" E	397691.6060	1716084.1930
8	15° 31' 14.1767" N	74° 02' 43.5612" E	397625.4070	1716136.7140
9	15° 31' 16.6423" N	74° 02' 42.3407" E	397589.3840	1716212.6430
10	15° 31' 19.0048" N	74° 02' 40.5389" E	397536.0260	1716285.4780
11	15° 31' 20.7947" N	74° 02' 39.0938" E	397493.2180	1716340.6710
12	15° 30' 59.3782" N	74° 02' 26.0745" E	397102.3850	1715684.3070
13	15° 30' 45.4427" N	74° 02' 22.2451" E	396986.3700	1715256.6010
14	15° 30' 41.3091" N	74° 02' 27.8454" E	397152.6600	1715128.8320
15	15° 30' 40.3990" N	74° 02' 46.0873" E	397696.0460	1715098.4580
16	15° 30' 39.4211" N	74° 03' 06.0043" E	398289.3310	1715065.7560

SURVEY NUMBER WISE AREA WITHIN MINING LEASE					
Village	Survey No.	Area (Ha.)	Village	Survey No.	Area (Ha.)
Surla	160 Part	0.2577	Surla	186 Part	20.0000
Surla	161 Part	0.7061	Surla	187 Part	7.2400
Surla	162 Part	4.3222	Surla	188 Part	3.2300
Surla	163	2.7450	Surla	218 Part	0.3533
Surla	164	0.5850	Surla	222 Part	1.5152
Surla	165	1.9475	Surla	223 Part	1.8940
Surla	166 Part	2.4126	Surla	224 Part	3.1996
Surla	167 Part	0.3504	Surla	225 Part	0.1062
Surla	171 Part	0.8131	Surla	226 Part	0.2167
Surla	180 Part	3.3580	Surla	232 Part	0.0045
Surla	181 Part	2.7339	Surla	233 Part	0.0160
Surla	182 Part	0.8366	Surla	428	3.0900
Surla	183	7.9200	Road		1.0061
Surla	184	21.3000	Nalla		0.1103
Surla	185 Part	1.1800	TOTAL		93.9500

LEGEND	
	LEASE BOUNDARY PILLARS
	LEASE BOUNDARY
	VILLAGE BOUNDARY
	SURVEY NUMBER BOUNDARY
	ROAD
	NALLA / RIVER

Directorate of Mines & Geology, Panaji - Goa	
Checked By	Certified By
Surveying Officer	Director of Mines & Geology

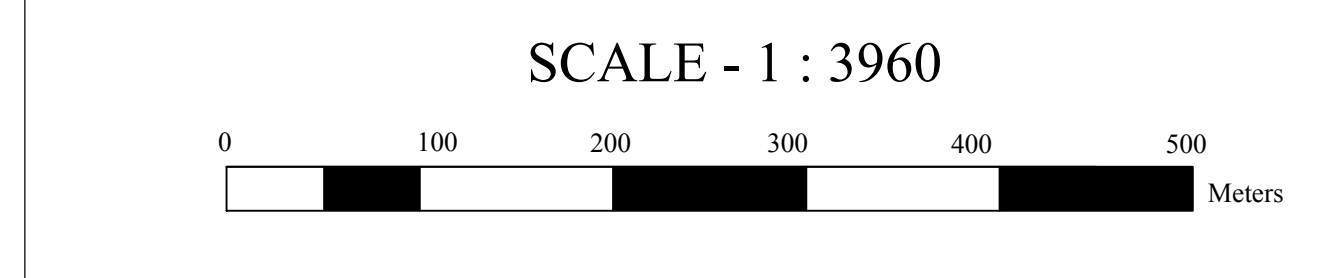

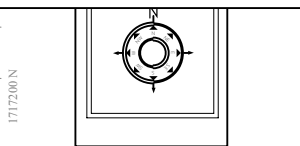
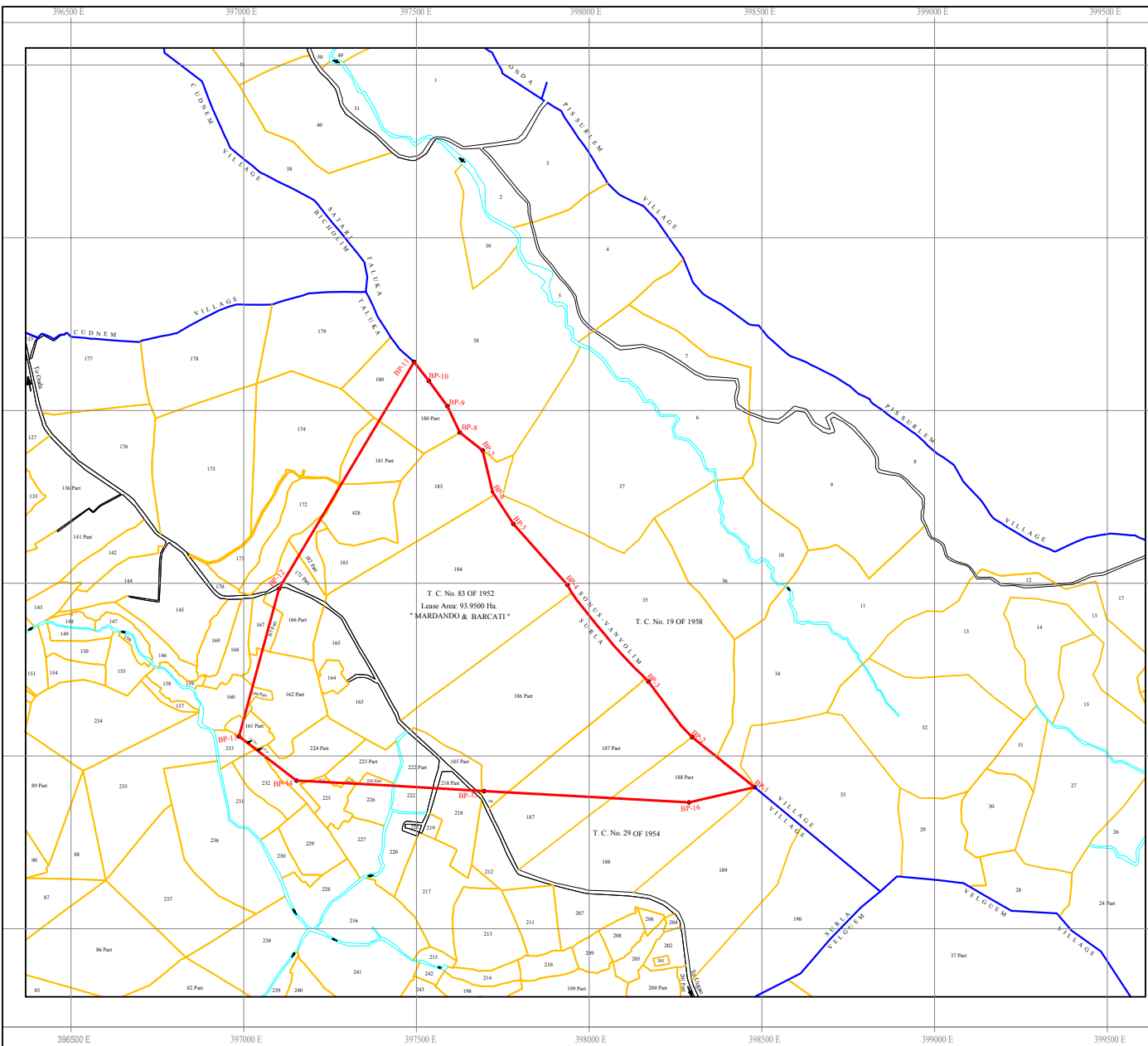

MAP DATUM - WGS 84
PROJECTION - UTM, Zone: 43 North

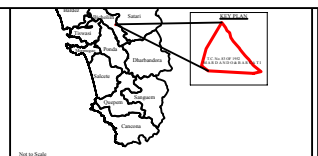

Geo Referenced and Vectorised Cadastral Map of T. C. No. 83 OF 1952
Lease Name: MARDANDO & BARCATTI
Lessee: V.M. SALGAOCAR & BRO. PVT. LTD.
Location: Situated in Village Surla of Bicholim Taluka, North Goa District, Goa State.
Area : 93.9580

B.P.No	LATITUDE	LONGITUDE	EASTING	NORTHING
1	15° 30' 48.8777" N	76° 02' 12.8627" E	388478.8980	171399.6685
2	15° 30' 48.1938" N	76° 02' 48.2847" E	392628.6292	171428.4323
3	15° 30' 58.7727" N	76° 02' 48.2847" E	392628.6292	171428.4323
4	15° 30' 58.8268" N	76° 02' 48.2847" E	392628.6292	171428.4323
5	15° 31' 01.8784" N	76° 02' 48.2847" E	392628.6292	171428.4323
6	15° 31' 01.8784" N	76° 02' 48.2847" E	392628.6292	171428.4323
7	15° 31' 12.4777" N	76° 02' 48.2847" E	392628.6292	171428.4323
8	15° 31' 14.1767" N	76° 02' 48.2847" E	392628.6292	171428.4323
9	15° 31' 18.6423" N	76° 02' 48.2847" E	392628.6292	171428.4323
10	15° 31' 19.0888" N	76° 02' 48.2847" E	392628.6292	171428.4323
11	15° 31' 26.7847" N	76° 02' 48.2847" E	392628.6292	171428.4323
12	15° 30' 58.1938" N	76° 02' 48.2847" E	392628.6292	171428.4323
13	15° 30' 48.8268" N	76° 02' 48.2847" E	392628.6292	171428.4323
14	15° 30' 48.8268" N	76° 02' 48.2847" E	392628.6292	171428.4323
15	15° 30' 48.8268" N	76° 02' 48.2847" E	392628.6292	171428.4323
16	15° 30' 39.4217" N	76° 02' 48.2847" E	392628.6292	171428.4323

Village	Survey No.	Area (Ha)	Village	Survey No.	Area (Ha)
Surla	188 Part	0.2217	Surla	191 Part	0.2000
Surla	191 Part	0.7891	Surla	193 Part	7.2400
Surla	195 Part	0.1222	Surla	198 Part	1.4400
Surla	199	2.1499	Surla	201 Part	0.1444
Surla	198	1.1191	Surla	202 Part	0.1444
Surla	199	1.9473	Surla	203 Part	1.4400
Surla	198 Part	0.1484	Surla	204 Part	0.2000
Surla	197 Part	0.1294	Surla	205 Part	0.4400
Surla	177 Part	0.1111	Surla	206 Part	0.2400
Surla	180 Part	0.1800	Surla	207 Part	0.2000
Surla	182 Part	0.1719	Surla	208 Part	0.2000
Surla	183 Part	0.1304	Surla	209	0.2000
Surla	185	0.1800	Surla	210	0.8000
Surla	184	0.1800	Surla	211	0.1122
Surla	186 Part	0.1100	Surla	212	0.1100

SURVEYED & PREPARED BY
M/s. GEOFINY TECHNOLOGIES (P) LIMITED
No.352/1B, BABY GANDEE SALGOMBE, TAMBARAM TALUK, CHENNAI-600 119.
Empanelled by
Directorate of Mines and Geology
Govt of GOA, PANAJI
Vide order no 91/1953/10-mine/203 Dated: 05/04/2013
Survey carried-out on 16th May 2013

CERTIFICATE
This is to certify that the Mining lease boundary pillars of T. C. No. 83 of 1952 have been surveyed using DGPS (Differential Global Positioning System) based up on the Total Station survey conducted earlier.

Mr. B. U. Umkristhan Nair
(mines Manager)

CERTIFICATE
This is to certify that the boundary pillars of T. C. No. 83 of 1952 as shown by Mr. B. U. Umkristhan Nair (Mines Manager) has been surveyed by our team led by Mr. K. Velumangan using DGPS. The lease map and pillar locations have been verified, survey conducted and plans prepared as per requirement of IBM circular No 2 / 2010 Dated 06-04-2010.

For Geofiny Technologies (P) Ltd.
K. Velumangan

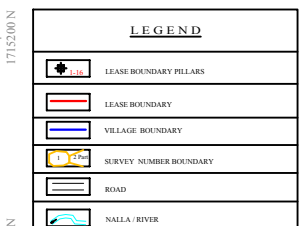

Directorate of Mines & Geology, Panaji - Goa
Checked By _____ Certified By _____
Surveying Officer _____ Director of Mines & Geology

